

HEALTHCARE DESIGN

ARCHITECTURAL SHOWCASE OUTPATIENT LITHOTRIPSY CENTER

The COR Group NEW YORK, NY
Metropolitan Lithotripter Associates, PC WHITE PLAINS, NY



Metropolitan Lithotripter Associates, PC, expanded its Westchester facility into 5,600 square feet of a former mechanical space, within the same building it previously occupied, to introduce new services that previously could not be provided because of lack of space. In light of the facility's affluent location, the design challenge was to create a comfortable environment for patients and their families while providing a state-of-the-art outpatient center that could accommodate a variety of treatment modalities. The facility's main area of treatment consists of the nonsurgical treatment of kidney stones.

The facility, designed with an accessible entry at street level, opens into a lobby/reception area belting of its surroundings. Patients, physicians, and staff are greeted by the inviting design of the reception desk and architectural wall, with its distinct

horizontal lines, frosted glass, and warmth of dark stained maple wood. The color scheme was selected to complement the natural light entering the space through the expansive exterior window wall. The high ceiling at reception clearly separates it from the adjacent waiting area. A vaulted ceiling with perimeter lighting provides a soft glow on overcast days, identifying the space in its nontraditional waiting room setting.

The open-plan format of the interior/clinical area allows observation of patients by the staff at all times without compromising patient privacy. This addresses a design criteria set by the client that the facility remain operational during periods in which minimal staff were available. Using glass vision panels throughout several areas, clinical staff can observe the pre-op area, reception, and recovery from any one location.

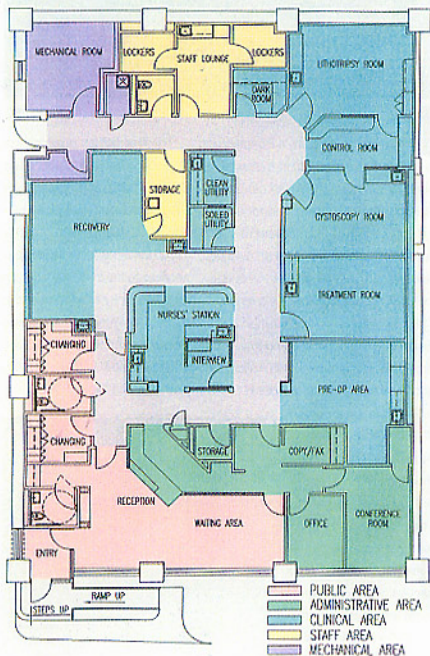

Project category: Conversion (completed January 2004)
Chief administrator: David Mandel, President and COO, (646) 742-8800
Firm: The COR Group, (212) 337-9575
Design team: Joe Bglano, President; James Ogdan, Architect; Desirée Arias, Project Executive (The COR Group); Lou Sgroo, President (Lou Sgroo, Equipment Planner); Tod O'Rourke, Senior Vice-President (ICS Builders, Inc.)
Photography: Norman McGrath
Total building area (sq. ft.): 5,600
Construction cost/sq. ft.: \$214
Total cost (excluding land): \$1,200,000